

1 Extenso

Willem van Ast

2009

2a Standard

recycle flatpack duramas

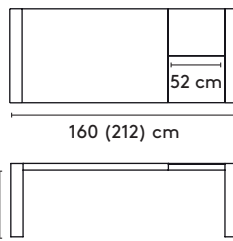
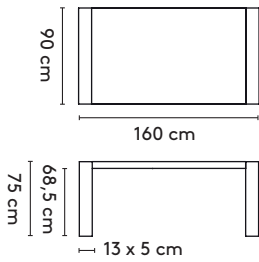

160 x 90 x 75 cm 280 x 100 x 75 cm
 180 x 90 x 75 cm 320 x 100 x 75 cm
 210 x 100 x 75 cm 360 x 100 x 75 cm
 240 x 100 x 75 cm

160 (212) x 90 x 75 cm
 180 (232) x 90 x 75 cm
 210 (262) x 100 x 75 cm
 240 (292) x 100 x 75 cm

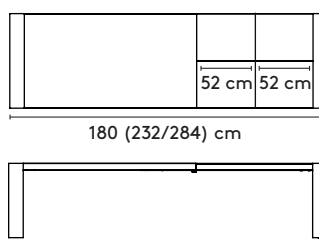
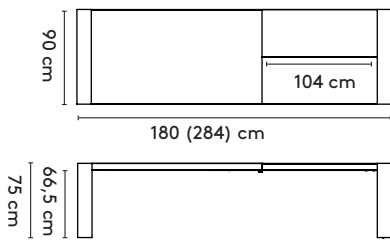

180 (284) x 90 x 75 cm
 210 (314) x 100 x 75 cm
 240 (344) x 100 x 75 cm

180 (232/284) x 90 x 75 cm
 210 (262/314) x 100 x 75 cm
 240 (292/344) x 100 x 75 cm

2b Tailoring

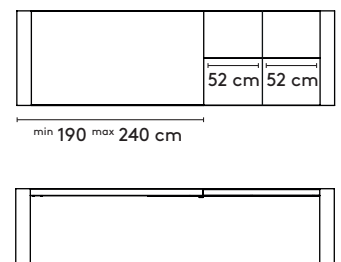
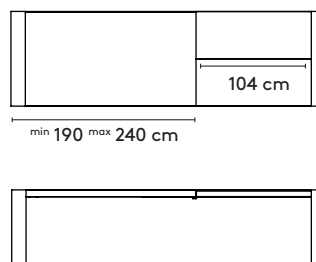
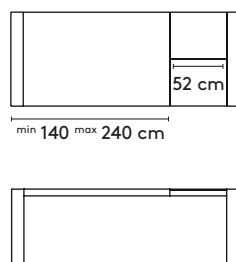
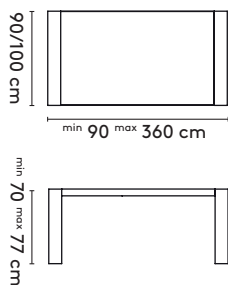

3 Materials

Top: oak or walnut (duramas)
Extension leaf: oak or walnut (duramas)
Base: oak or walnut (solid)

Materialen

Blad: eiken of noten (duramas)
Uitschuifblad: eiken of noten (duramas)
Onderstel: eiken of noten (massief)

Materialien

Platte: Eiche oder Nussbaum (Duramas)
 Einlegeplatte: Eiche oder Nussbaum (Duramas)
 Untergestell: Eiche oder Nussbaum (Massiv)

4 Finishes

All Arco colors and finishes for the mentioned materials

Afwerkingen

Alle Arco kleuren en (lak)afwerkingen voor de genoemde materialen

Ausführungen

Alle Arco Farben und Ausführungen für die genannten Materialien

5 Additional information

* Zipper sock in combination with CM06 or CM07 only
 Cable management including electrification optional

Aanvullende informatie

* Zipper sock uitsluitend met CM06 of CM07
 Cable management met elektrificatie mogelijk

Weitere Informationen

* Zipper sock nur mit CM06 oder CM07
 Cable management mit Elektrifizierung möglich

6 Cable management

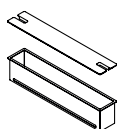

CM06/CM07 epoxy
 30/50 cm



CM08/CM09 cable-net
 small/large



CM12 cable sock
 large



CM13* zipper sock